

BES M18MF-GOC70B-S04G
BES02NL

polarized
NC
flush mountable

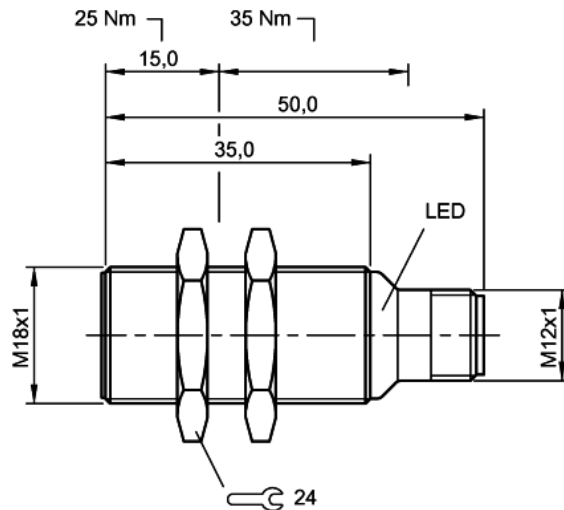

Electrical data:

Time delay before availability	50 ms
Electrical type	DC
Utilization category	DC 13
Hysteresis max (H)	20 %
Minimum operating current (I _m)	5 mA
Off-state current max (I _r)	600 µA
Ripple of power supply	15 %
Switching output	polarized
Switching element function	NC
Operating frequency (f)	600 Hz
Voltage drop static max	4 V
Supply voltage max DC (U _B)	36 V
Supply voltage min DC (U _B)	10 V
Rated operational voltage DC	24 DC V
Rated operational current (I _e)	100 mA
Connection	Connector

General data:

Power Indication	no
Output indication	yes
Short circuit protected	yes
Brand	GlobalProx
Degree of protection IP	IP67
Protected against polarity reversal	yes
Approval	CE

Wiring:

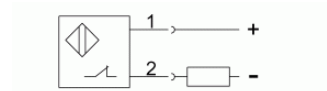

Mechanical data:

Number of Wires	2-wire
Tightening torque	25/35 Nm
Rated operating distance (sn)	7 mm
Diameter	M18x1 mm
Assured operating distance	0...5,6 mm
Mounting	flush mountable
Ambient temperature max	+70 °C
Ambient temperature min	-25 °C
Degree of pollution	3
Sensing face material	PA 12
Housing material	CuZn, Ni free coated
Repeat accuracy max. (R)	5 %