

OEV W 18 M 20000 P4K-IBSL Through Beam Sensor, Receiver

- Compact design, Angled optics
- Red light clocked
- High resolution, operating frequency, functional reserve
- LED indication of output state and functional reserve
- High operating distance

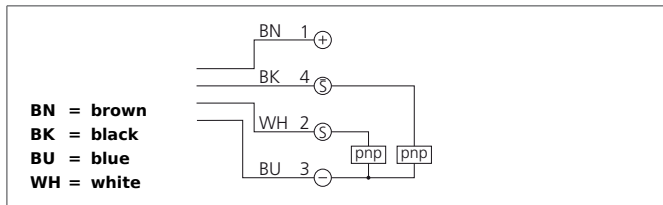

Safety instructions

The Instruments are not to be used for safety applications, in particular applications in which safety of persons depends on proper operation of the instruments.

These instruments shall exclusively be used by qualified personnel.
 Repair only by di-soric.

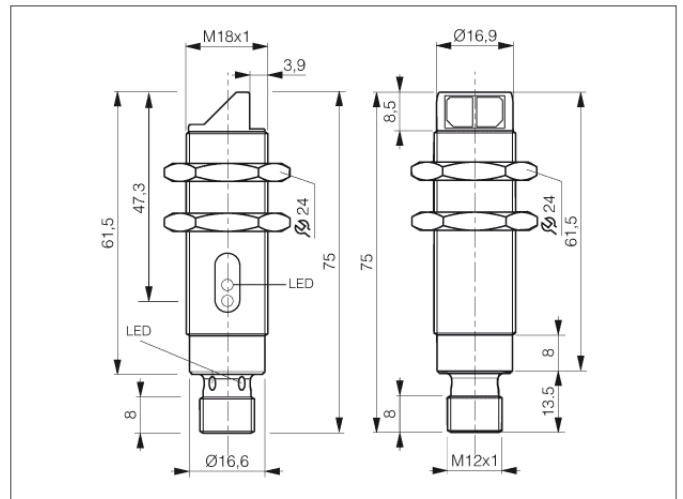

TECHNICAL INFORMATION		+20°C, 24V DC
Size		M18 (Gewinde)
Design		screw
Operating distance		20.000 mm
Service voltage		10 ... 36 V DC
Transmitter / receiver		receiver
Output		pnp, 200 mA, exclusive OR
Internal power consumption		< 15 mA
Voltage drop		< 2,0 V
Operating frequency		1.000 Hz
Response-/release time		< 0,5 ms / < 0,5 ms
Switching hysteresis		< 10 %
Ambient temperature		-25 ... +55 °C
Ambient light immunity		> 10 kLx
Insulation voltage endurance		1.000 V
Protection class		IP 67
Casing material		brass nickel plated
Connection		Connector, M12, 4-poled