

ORV W 18 M 2000 P2K-IBSL

Retroreflective Sensor

- Compact design, Angled optics
- Red light clocked
- Polarized filter
- High resolution, operating frequency, functional reserve
- LED indication of output state and functional reserve
- High operating distance

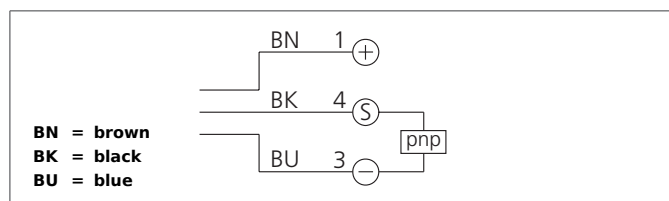

Safety instructions

The Instruments are not to be used for safety applications, in particular applications in which safety of persons depends on proper operation of the instruments.

These instruments shall exclusively be used by qualified personnel.

Repair only by di-soric.

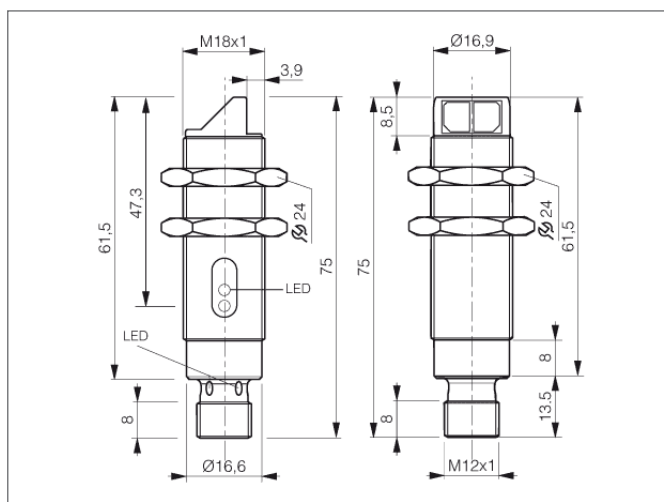

TECHNICAL INFORMATION	
Size	+20°C, 24V DC M18 (Gewinde)
Design	screw
Emitted light	Red, 660 nm, clocked, polarized
Operating distance	2.000 mm
Service voltage	10 ... 36 V DC
Referring reflector	Ø 84 mm
Output	pnp, 200 mA, NO
Sensitivity adjustment	potentiometer
Internal power consumption	< 20 mA
Voltage drop	< 2,0 V
Operating frequency	1.000 Hz
Response-/release time	< 0,5 ms / < 0,5 ms
Ambient temperature	-25 ... +55 °C
Ambient light immunity	> 10 kLx
Insulation voltage endurance	1.000 V
Protection class	IP 67
Casing material	brass nickel plated
Material	glass (Window)
Connection	Connector, M12, 3-poled