

# OSV 18 M 20000-IBSL

## Through Beam Sensor, Transmitter

- Compact design
- Red light clocked
- High resolution, operating frequency, functional reserve
- LED indication of output state and functional reserve
- High operating distance
- Transmitter test function

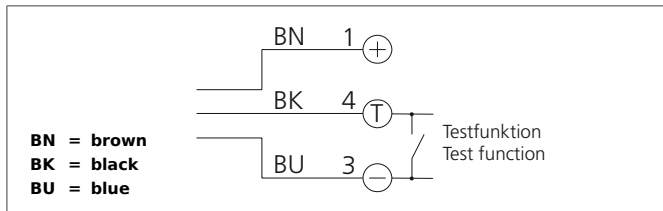

### Safety instructions

The Instruments are not to be used for safety applications, in particular applications in which safety of persons depends on proper operation of the instruments.  
These instruments shall exclusively be used by qualified personnel.  
Repair only by di-soric.

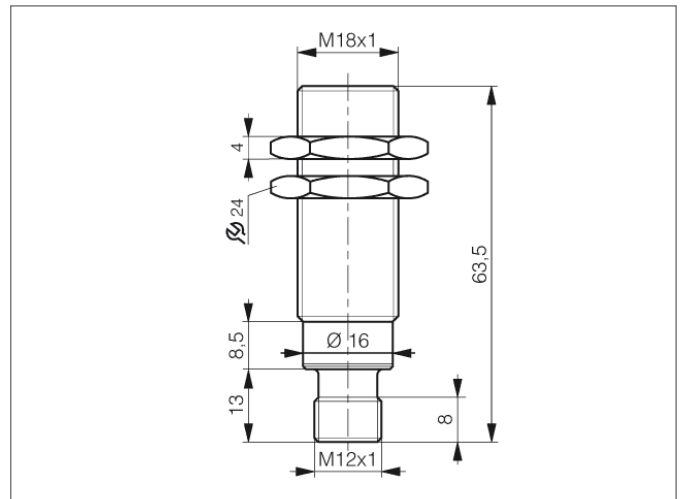

TECHNICAL INFORMATION		+20°C, 24V DC
Size		M18 (Gewinde)
Design		screw
Emitted light		Red, 660 nm, clocked
Operating distance		20.000 mm
Service voltage		10 ... 36 V DC
Transmitter / receiver		transmitter
Internal power consumption		< 15 mA
Operating frequency		1.000 Hz
Ambient temperature		-25 ... +55 °C
Insulation voltage endurance		1.000 V
Protection class		IP 67
Casing material		brass nickel plated
Connection		Connector, M12, 3-poled