

OSV 30 K 6000-TSSL

Through Beam Sensor, Transmitter

- Small design
- Infrared light, clocked
- 12-turn potentiometer
- Sensitivity adjustable, large operating distance
- Transmitter test function
- LED indication of output state and functional reserve

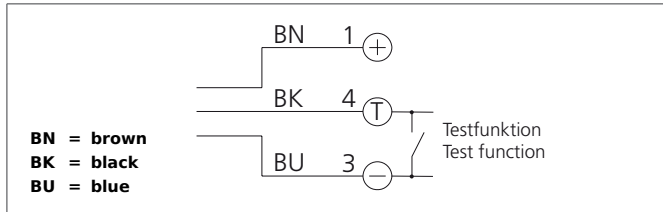

Safety instructions

The Instruments are not to be used for safety applications, in particular applications in which safety of persons depends on proper operation of the instruments.
These instruments shall exclusively be used by qualified personnel.
Repair only by di-soric.

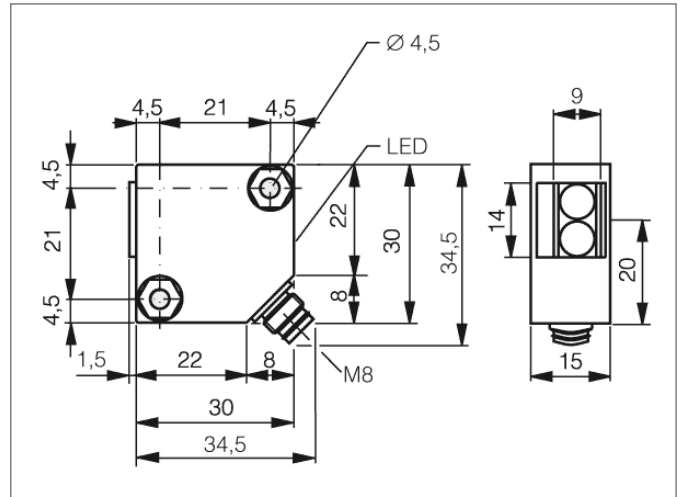

| TECHNICAL INFORMATION | |
|------------------------------|---|
| Size | +20°C, 24V DC 30 x 30 x 15 mm (Dimensions) |
| Design | cuboid design |
| Emitted light | Infrared, 880 nm, clocked |
| Operating distance | 6.000 mm |
| Service voltage | 10 ... 36 V DC |
| Transmitter / receiver | transmitter |
| Internal power consumption | < 15 mA |
| Operating frequency | 1.000 Hz |
| Ambient temperature | -25 ... +55 °C |
| Insulation voltage endurance | 1.000 V |
| Protection class | IP 67 |
| Casing material | plastics |
| Connection | Connector, M8, 3-poled |
| | |
| | |
| | |
| | |
| | |
| | |
| | |
| | |
| | |