

OKTTI 55 M 30 FG3LK-IBS

Optical Contrast Sensor

- Contrast diffuse sensor with high resolution for detecting print marks
- Teach-in key / remote teach option / lock function
- Auto-teach during a running process
- LED indicator for the teach procedure
- Robust metal casing

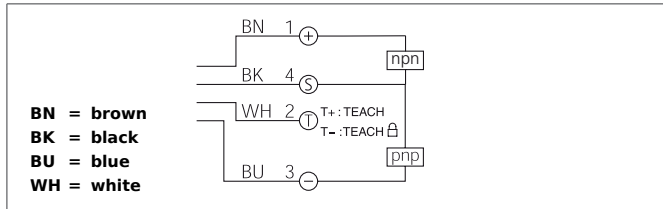

Safety instructions

The Instruments are not to be used for safety applications, in particular applications in which safety of persons depends on proper operation of the instruments.
 These instruments shall exclusively be used by qualified personnel.
 Repair only by di-soric.

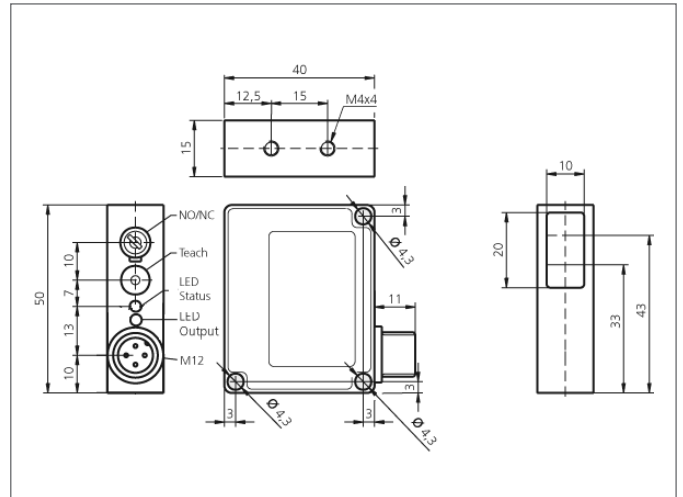

TECHNICAL INFORMATION		+20°C, 24V DC
Emitted light		White, clocked
Service voltage		10 ... 35 V DC
Diameter of light spot		Ø 3 mm
Operating distance		30 ± 3 mm
Output		Push pull, 200 mA, NO/NC, switchable
Sensitivity adjustment		teach key + remote teach
Internal power consumption		< 40 mA
Voltage drop		< 2,0 V
Operating frequency		3.000 Hz
Resolution		Ø 0,7 mm
Switching hysteresis		< 0,01 mm
Ambient temperature		-10 ... +60 °C
Ambient light immunity		> 20 kLx
Insulation voltage endurance		500 V
Protection class		IP 67
Casing material		die-cast zinc lacquered finish
Material		polycarbonate (Window)
Connection		Connector, M12, 4-poled