

LVTI 51 M 600 FP3K-IBS

Laser Diffuse Sensor

- red light laser, clocked with small laser spot
- Teach function
- Remote teach option with key-lock function
- Functional reserve indicator/contamination indicator
- Bright LED
- Light/dark switching

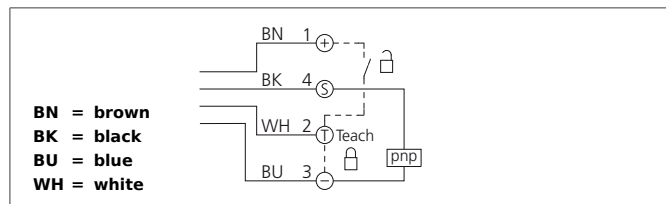

Safety instructions

Inproper use may result in hazardous radiation exposure. Pay attention to accident prevention rules and laser class. The instruments are not to be used for safety applications, in particular applications in which safety of persons depends on proper operation of the instruments. These instruments shall exclusively be used by qualified personnel. Repair only by di-soric.

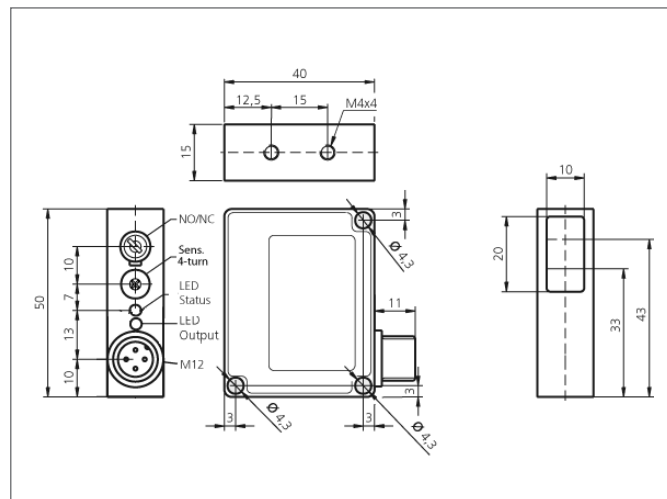

TECHNICAL INFORMATION		+20 °C, 24V DC
Evaluation		digital
Size		50 x 40 x 15 mm (Dimensions)
Design		cuboid design
Emitted light		Red light laser, 650 nm, clocked
Service voltage		10 ... 35 V DC
background suppression		no
Diameter of light spot		Ø 1,5 mm
Operating distance		100 ... 600 mm
Laser class		2 (EN 60825-1)
Output		pnp, 200 mA, NO/NC, switchable
Sensitivity adjustment		teach key + remote teach
Internal power consumption		30 mA
Operating frequency		500 Hz
Switching hysteresis		< 10 %
Reproducibility		< 2 %
Ambient temperature		-10 ... +50 °C
Ambient light immunity		> 5 kLx
Protection class		IP 67
Casing material		die-cast zinc lacquered finish
Connection		Connector, M12, 4-poled