

## OEP 12 V 20000 G1L-5M

### High Performance Photoelectric Sensor, Receiver

- Operating distances up to 20 m
- Integrated amplifier electronics
- Transistor output with push-pull
- Extremely dirt-resistant
- Easy adjustment
- Different designs to be combined
- High protection class
- Compact design

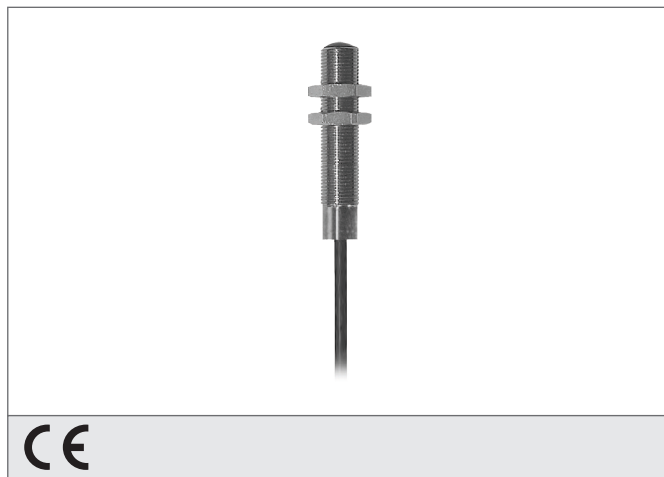

CE

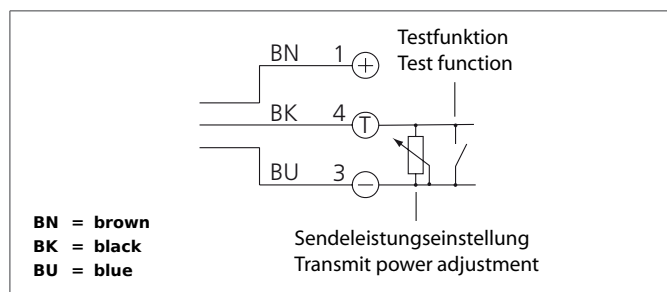

#### Safety instructions

The Instruments are not to be used for safety applications, in particular applications in which safety of persons depends on proper operation of the instruments.  
These instruments shall exclusively be used by qualified personnel.  
Repair only by di-soric.

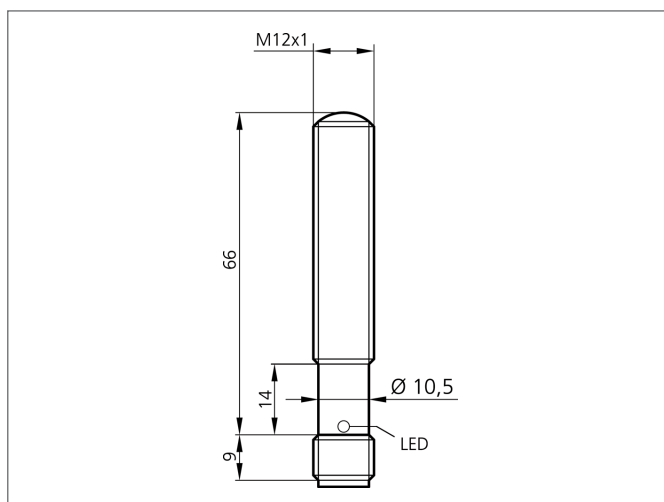

TECHNICAL INFORMATION		+20°C, 24V DC
Size		M12 x 1 (Gewinde)
Design		screw
Operating distance		0 ... 20.000 mm
Service voltage		10 ... 35 V DC
Transmitter / receiver		receiver
Output		Push pull, 200 mA, NC
Internal power consumption		< 40 mA
Shock-/vibration load		10 ... 55 Hz / 2,0 mm / 30 g
Operating frequency		150 Hz
Ambient temperature		-20 ... +60 °C
Ambient light immunity		> 15 kLx, Sunlight, > 2 kLx, g
Protection class		IP 67, IP 68, IP 69K
Casing material		stainless steel
Connection		cablE PVC, 5.000 mm