

## OEP 12 V 50000 G2L-5M

### High Performance Photoelectric Sensor, Receiver

- High operating distance up to 50 m
- Integrated amplifier electronics
- Transistor output with push-pull
- Extremely dirt-resistant
- Easy adjustment
- Different designs to be combined
- High protection class
- Compact design

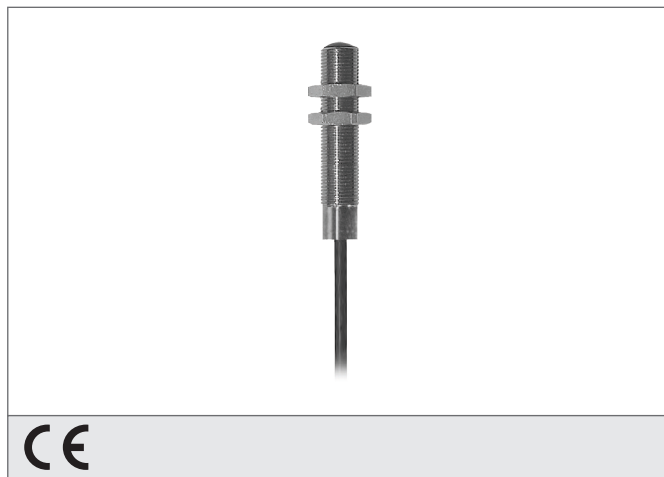

CE

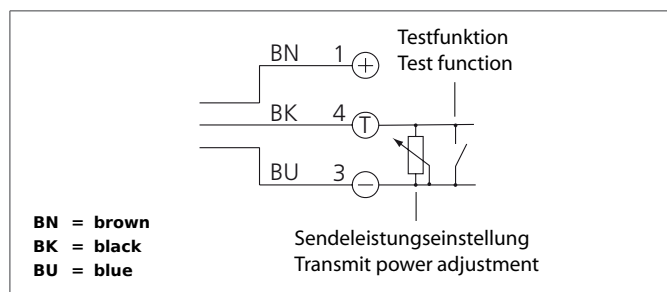

#### Safety instructions

The Instruments are not to be used for safety applications, in particular applications in which safety of persons depends on proper operation of the instruments.  
These instruments shall exclusively be used by qualified personnel.  
Repair only by di-soric.

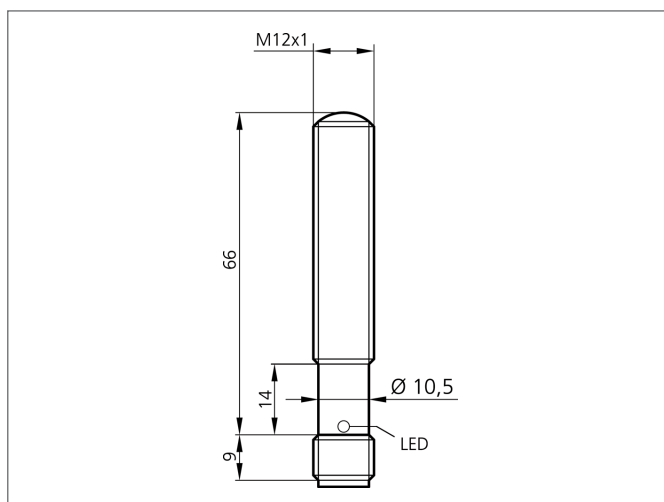

| TECHNICAL INFORMATION      |  | +20°C, 24V DC                  |
|----------------------------|--|--------------------------------|
| Size                       |  | M12 x 1 (Gewinde)              |
| Design                     |  | screw                          |
| Operating distance         |  | 0 ... 50.000 mm                |
| Service voltage            |  | 10 ... 35 V DC                 |
| Transmitter / receiver     |  | receiver                       |
| Output                     |  | Push pull, 200 mA, NO          |
| Internal power consumption |  | < 40 mA                        |
| Shock-/vibration load      |  | 10 ... 55 Hz / 2,0 mm / 30 g   |
| Operating frequency        |  | 20 Hz                          |
| Ambient temperature        |  | -20 ... +60 °C                 |
| Ambient light immunity     |  | > 15 kLx, Sunlight, > 2 kLx, g |
| Protection class           |  | IP 67, IP 68, IP 69K           |
| Casing material            |  | stainless steel                |
| Connection                 |  | cablc PVC, 5.000 mm            |