

# **OEV W 18 M 20000 N4K-IBSL** **Through Beam Sensor, Receiver**

- Compact design, Angled optics
- Red light clocked
- High resolution, operating frequency, functional reserve
- LED indication of output state and functional reserve
- High operating distance

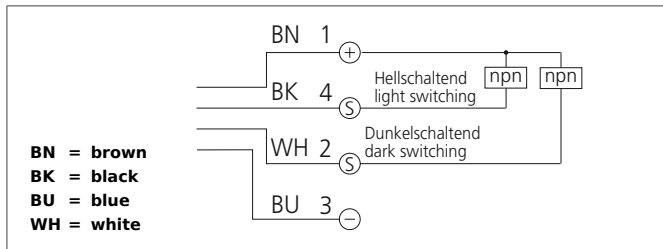

## **Safety instructions**

The Instruments are not to be used for safety applications, in particular applications in which safety of persons depends on proper operation of the instruments.  
 These instruments shall exclusively be used by qualified personnel.  
 Repair only by di-soric.

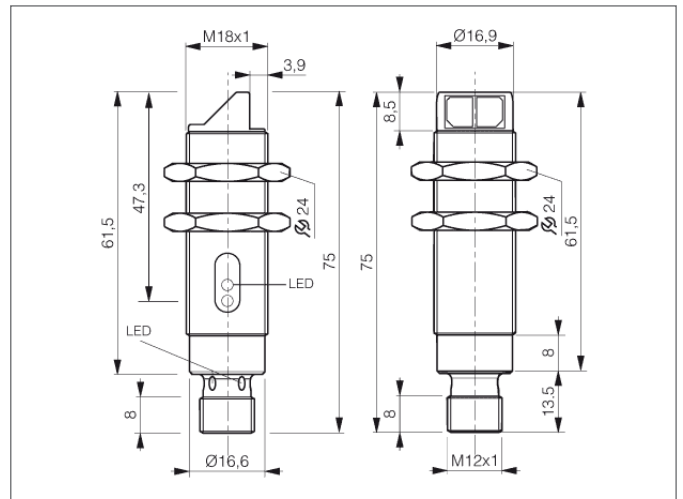

<b>TECHNICAL INFORMATION</b>	
Size	<b>+20°C, 24V DC</b> M18 (Gewinde)
Design	screw
Operating distance	20.000 mm
Service voltage	10 ... 36 V DC
Transmitter / receiver	receiver
Output	npn, 200 mA, exclusive OR
Internal power consumption	< 15 mA
Voltage drop	< 2,0 V
Operating frequency	1.000 Hz
Response-/release time	< 0,5 ms / < 0,5 ms
Switching hysteresis	< 10 %
Ambient temperature	-25 ... +55 °C
Ambient light immunity	> 10 kLx
Insulation voltage endurance	1.000 V
Protection class	IP 67
Casing material	brass nickel plated
Connection	Connector, M12, 4-poled