

## Diffuse Sensor

- 

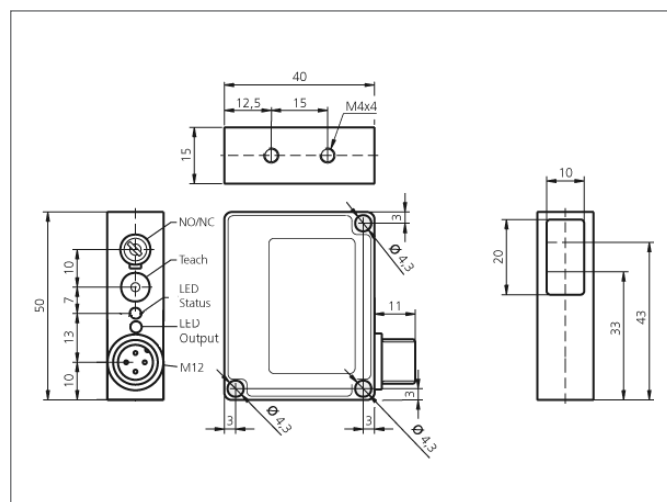
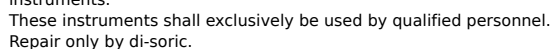

## +20°C, 24V DC

Operating principle	Diffuse reflective sensor
Evaluation	digital
Size	50 x 40 x 15 mm (Dimensions)
Design	cuboid design
Emitted light	Red, 660 nm, clocked
Service voltage	10 ... 35 V DC
Operating distance	15 ... 150 mm
Output	npn, 200 mA, NO/NC, switchable
Sensitivity adjustment	teach button
Internal power consumption	< 40 mA
Operating frequency	1.000 Hz
Switching hysteresis	12 %
Reproducibility	< 1 %
Ambient temperature	-10 ... +60 °C
Ambient light immunity	> 10.000 Lux
Protection class	IP 67
Protection degree	III, operation on protective low voltage
Casing material	die-cast zinc lacquered finish
Material	polycarbonate (Window)
Connection	Connector, M12, 3-poled