

# OTV 50 M 600 N3K-IBS

## Diffuse Sensor

- Infrared light, clocked
- 4-turn potentiometer
- Bright LED, Connector M8 with ring LED
- Dark-/light switching, push-pull
- Functional reserve indicator/contamination indicator
- Robust metal casing

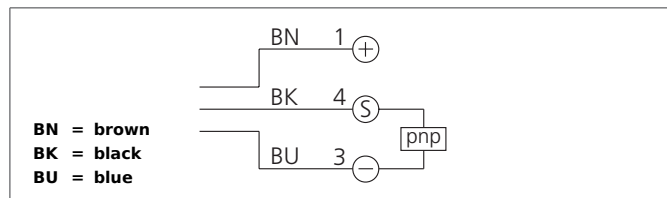

### Safety instructions

The Instruments are not to be used for safety applications, in particular applications in which safety of persons depends on proper operation of the instruments.

These instruments shall exclusively be used by qualified personnel.

Repair only by di-soric.

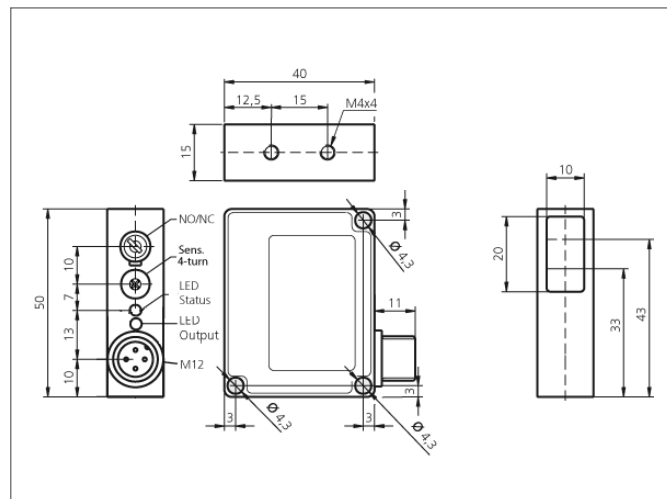

| TECHNICAL INFORMATION      |  |
|----------------------------|--|
| Operating principle        | +20°C, 24V DC<br>Diffuse reflective sensor |
| Evaluation                 | digital                                    |
| Size                       | 50 x 40 x 15 mm (Dimensions)               |
| Design                     | cuboid design                              |
| Emitted light              | Infrared, 880 nm, clocked                  |
| Service voltage            | 10 ... 35 V DC                             |
| Operating distance         | 100 ... 600 mm                             |
| Output                     | nnp, 200 mA, NO/NC, switchable             |
| Sensitivity adjustment     | potentiometer                              |
| Internal power consumption | < 45 mA                                    |
| Operating frequency        | 1.000 Hz                                   |
| Switching hysteresis       | 12 %                                       |
| Reproducibility            | < 1 %                                      |
| Ambient temperature        | -10 ... +60 °C                             |
| Ambient light immunity     | > 10.000 Lux                               |
| Protection class           | IP 67                                      |
| Protection degree          | III, operation on protective low voltage   |
| Casing material            | die-cast zinc lacquered finish             |
| Material                   | polycarbonate (Window)                     |
| Connection                 | Connector, M12, 3-poled                    |